

From: [Bruce Harrison](#)
To: [Fire Prevention and Building and Safety Commission](#); [Boyle, Douglas J \(DHS\)](#); [Thompson, Crystal](#)
Subject: Modification of Joyce Athletic Convocation Center Public Health Emergency COVID-19 University of Notre Dame
Date: Saturday, October 3, 2020 3:18:06 PM
Attachments: [2020-10-02_Joyce Center CRU Site Layout Map.pdf](#)

**** This is an EXTERNAL email. Exercise caution. DO NOT open attachments or click links from unknown senders or unexpected email. ****

Commission

The Joyce Athletic Convocation Center at the University of Notre Dame, 18801 Moose Krause South, Notre Dame, IN, 46556 (specifically North Dome/Fieldhouse) will be utilized for Public Health Emergency COVID-19. This soft modification of building use is considered to be temporary and Phase One is expected to last through the end of the current academic year (@May 11th, 2021)

This soft modification is to be utilized for diagnostic testing for COVID-19 for the University Community and other health related activities

This will consolidate testing at one site from the Stadium Gate D and a Membrane Structure that is in the East Quad. Those sites will be discontinued for COVID-19 testing

Relief from 675 IAC 12-4-11 (b) is requested as the proposal would not cause the structure to be unsafe particularly in regards to suitable means of egress and structural stability

Any questions or concerns please feel free to contact me

Thanks

Bruce

--

Bruce Harrison

Notre Dame Fire Chief

Firehouse Number: 574-631-6200

Cell: 574-339-1314



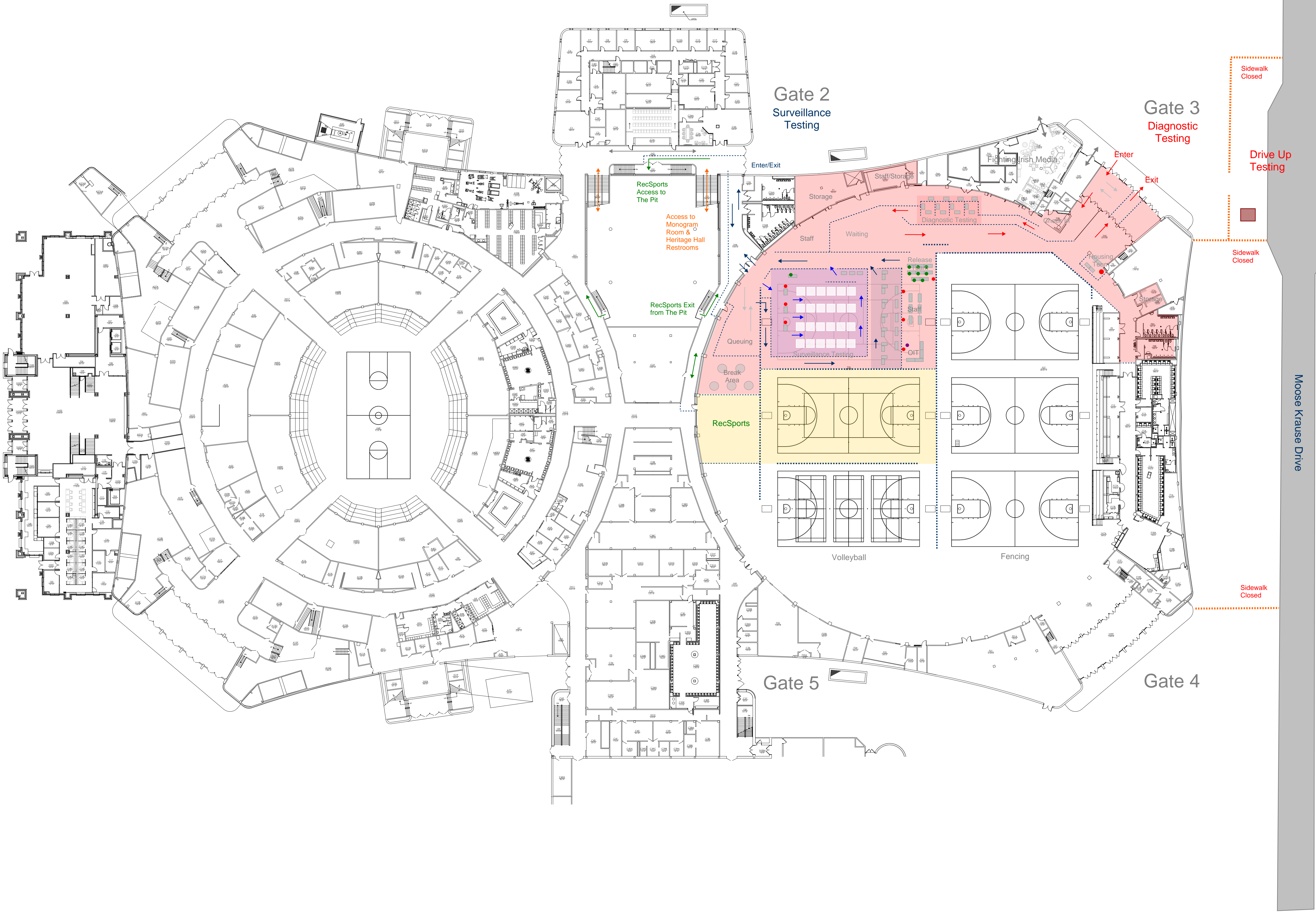

D	ADDED ROOM C34C & A24A - MDS	3/7/17	H	RENOVATIONS AT SECTION "C"	3/9/20
C	RENOVATED ROOM A7D - MDS	1/26/16	G	Renovations at F7, new locker rooms, new court striping	3/7/19
B	RENOVATED HOCKEY ARENA INTO FENCING - MDS	4/18/13	F	Renovated Rooms A18, A18A & A18B. Deleted 1H19B - MDS	3/20/18
A	ADDED DIGITAL MEDIA - MDS	4/16/13	E	ADDED FURNITURE TO RM 114 - MDS	3/16/17
REV	DESCRIPTION	DATE	REV	DESCRIPTION	DATE



UNIVERSITY OF
NOTRE DAME
Facilities Design & Operations

100 FACILITIES BUILDING
NOTRE DAME, IN 46556

(574) 631-6594
FAX: (574) 631-8468

BASE FLOOR PLAN JOYCE CENTER	DRAWN BY: WN/DM	DATE: 5/16/66	SCALE: 1/32" = 1' 0"
FIRST FLOOR	APPROVED:	DATE:	PROJECT PHASE:
	PRINT DATE:	----	
	DWG. NAME	108301	REV.